

ARRAY A
100 MODULES
5° TILT
10'-0" CLEARANCE

1
S3.0

SLOPE
DOWN

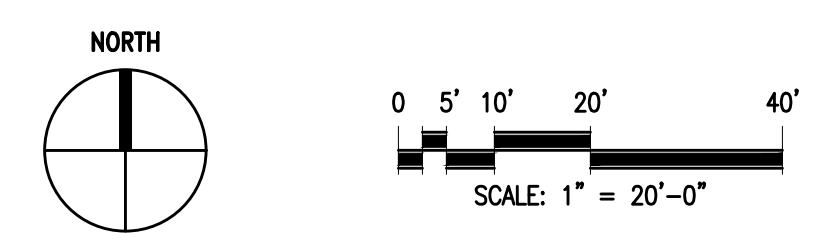

PV CANOPY LAYOUT PLAN
SCALE: 1"=20'

LEGEND

- SOLAR MODULE
TSM-DEG15MC.20(1), (100) TOTAL
- ZEE PURLIN
- 4 HIGH TILT UP SOLAR STRUCTURES AT 27°-0" MAX. (4) TOTAL
SEE DETAIL 1/S3.0

BATTERY HOST

200 Philips Dr.
Sausalito, CA 94965
415.332.3190

STRUCTURAL ENGINEER

MBL-ENERGY
SINCE 2002
1698 Rogers Ave, Suite 40
San Jose, CA 95112
888-885-4401

ELECTRICAL ENGINEER

Natron Resources, Inc.
954 Bayview Ave
Oakland, CA 94610
510.868.0701

ARCHITECT
M M P V design
718 West Arbor Drive
San Diego, CA 92103
619.632.2883

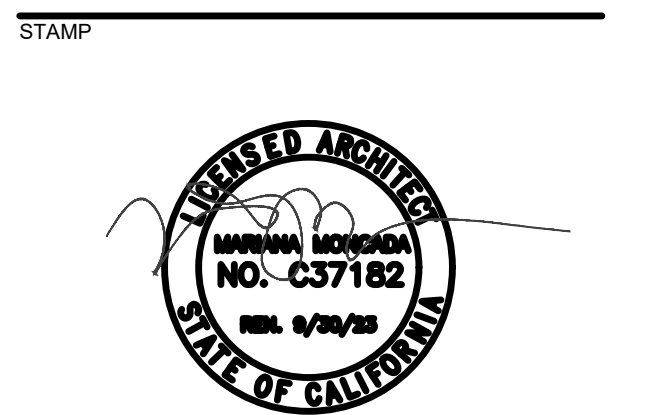

PROJECT
BAYSIDE MARTIN LUTHER KING JR. ACADEMY
200 PHILIPS DR.
SAUSALITO, CA 94965

NO.	REVISION	DATE
1	50P FOR CLIENT REVIEW	01.19.23

DATE: 01.19.23

SHEET TITLE
PV CANOPY LAYOUT PLAN
SHEET NO.

BA-A2.0

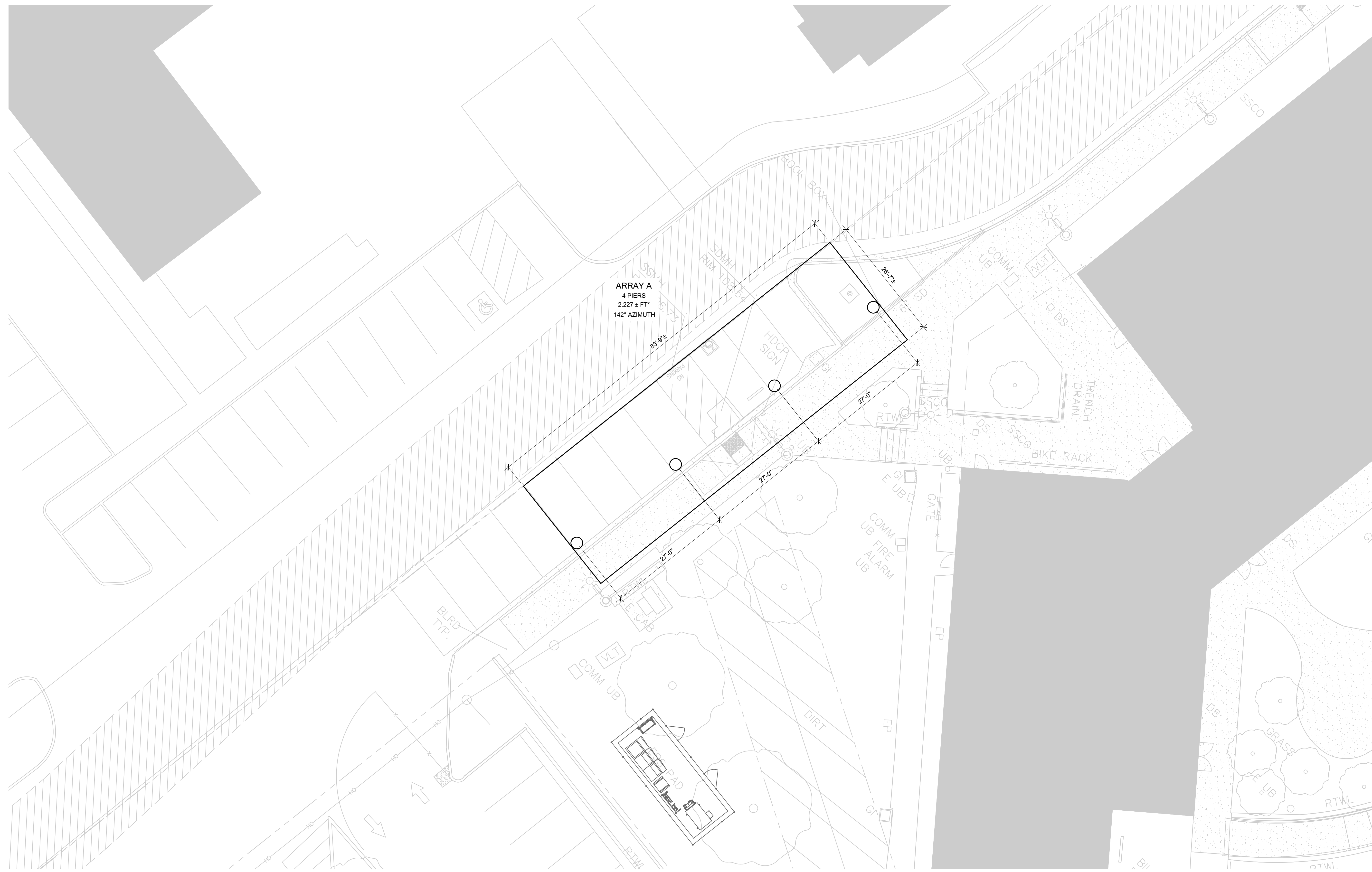

ARRAY A
4 PIERS
2,227 ± FT²
142° AZIMUTH



PV CANOPY FOUNDATION PLAN
SCALE: 1"=10'
NOTE: ARRAYS TO BE 20'-0" MIN FROM EXISTING BUILDINGS

LEGEND

○ 30" DIA GIDH CONCRETE PIER W/
ABOVE GRADE BOLLARD, TYP.

BATTERY HOST

200 Philips Dr.
Sausalito, CA 94965
415.332.3190

STRUCTURAL ENGINEER

MBL-ENERGY
SINCE 2002
1698 Rogers Ave, Suite 40
San Jose, CA 95112
888-885-4401

ELECTRICAL ENGINEER

Natron Resources, Inc.
954 Bayview Ave
Oakland, CA 94610
510.868.0701

ARCHITECT
M M P V design

718 West Arbor Drive
San Diego, CA 92103
619.632.2883

STAMP

PROJECT
BAYSIDE MARTIN LUTHER KING JR. ACADEMY
200 PHILIPS DR.
SAUSALITO, CA 94965

NO.	REVISION	DATE
1	50P FOR CLIENT REVIEW	01.19.23

DATE: 01.19.23

SHEET TITLE
PV CANOPY FOUNDATION PLAN

SHEET NO.

BA-A2.1